

**MODULER SYSTEM  
SWINGHANDLE**

**407**

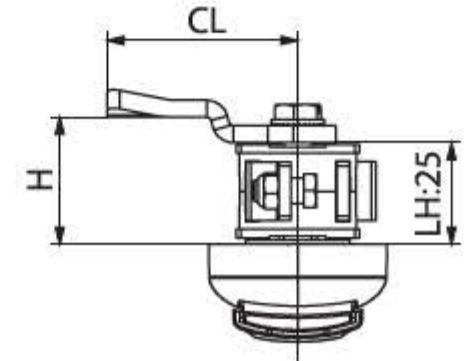
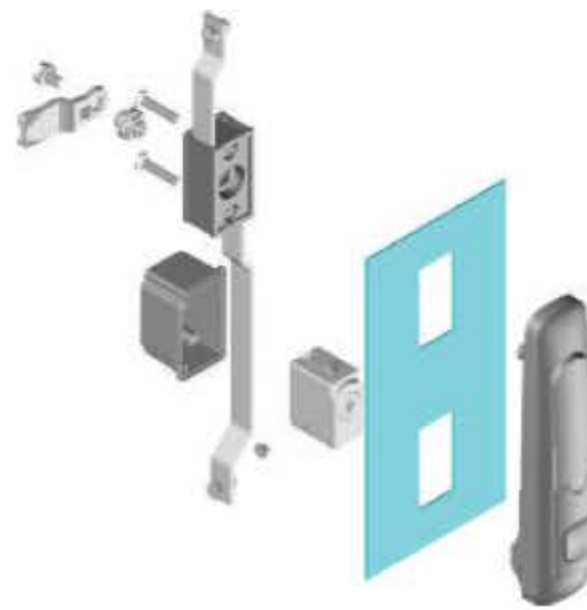
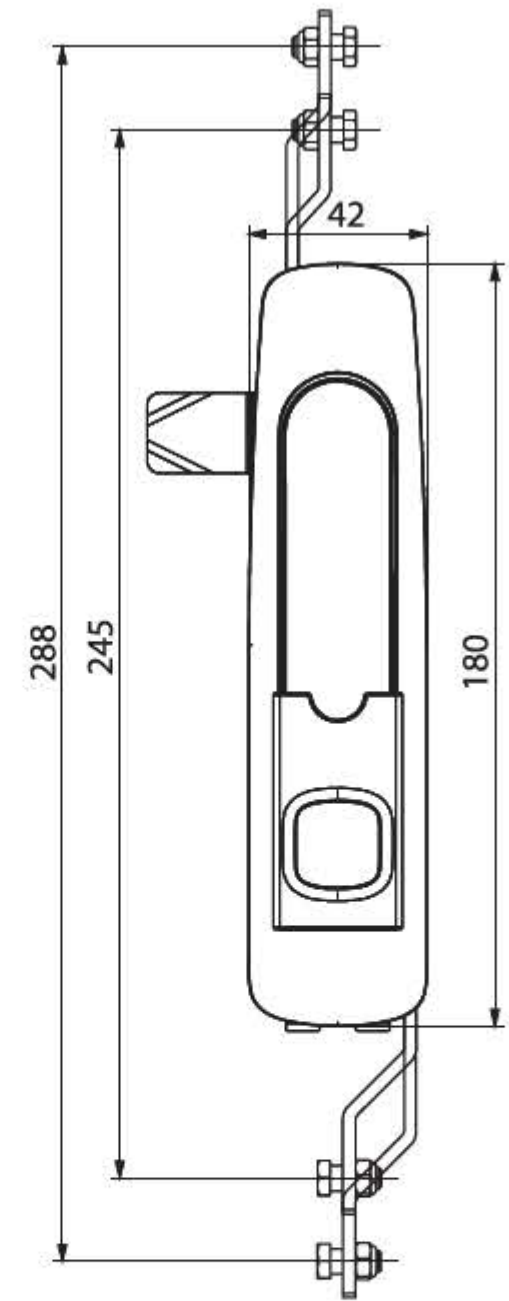
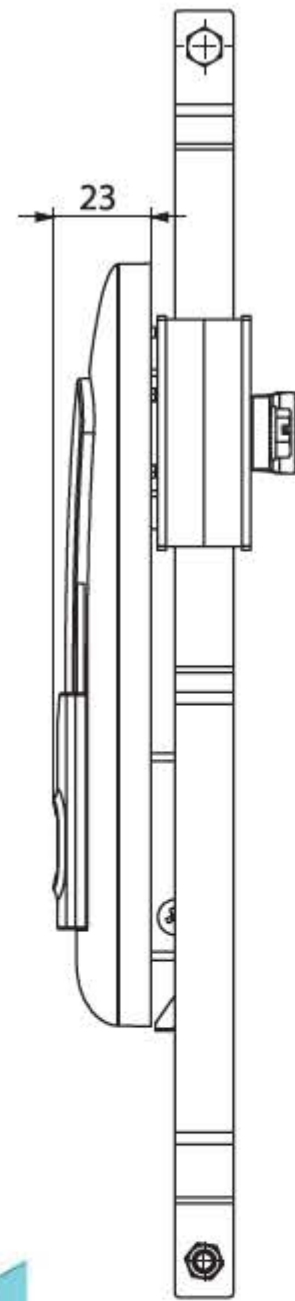
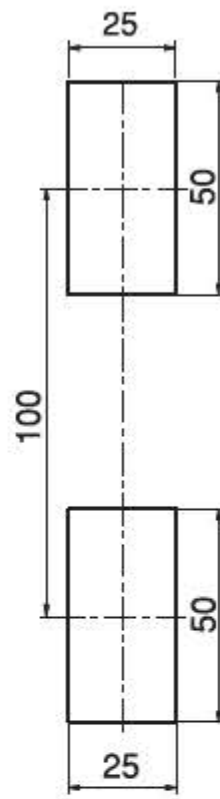

- Swing handle has a modular lock structure allows easy modification for customer requests
- Lock and modules could be ordered separately
- Single point locking and gearbox option is possible on same lock by an adaptor
- Padlock is optional
- Easy fixing option by plastic clips

**MATERIAL**

**BODY:** PA6 GFR 30  
**HANDLE:** Zamak DIN-EN 1774-ZnAl4Cu1  
**MECHANISM:** PA6 GFR 30  
**MODUL:** Zamak DIN-EN  
**CAM:** Steel

**PRODUCT CODE**

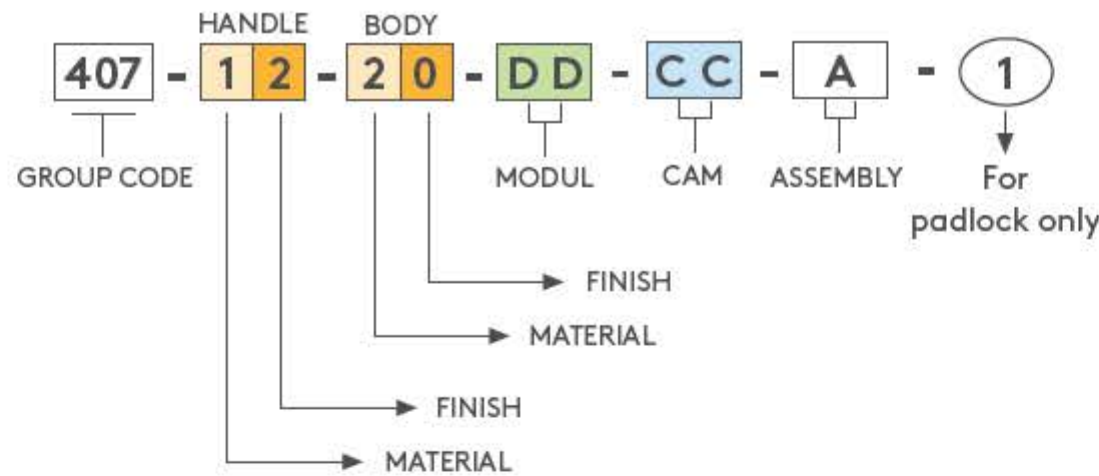

MATERIAL	M
Zamak	1
Plastic	2

FINISH	F
No finish	0
Black coated	2

	CYLINDER TYPE	
	DD	Order code
	03	MDL03
	32	MDL32
	05	MDL05
07	MDL07	



1 Padlock application

DRIVERS			BUTTON	CYLINDER
5 mm Double bit	8 mm Square	9 mm Triangular	Zamak	Brass
				
15	28	39	55	11
MDL15	MDL28	MDL39	MDL55	MDL11

