

016

PUSH-TO-CLOSE LOCK

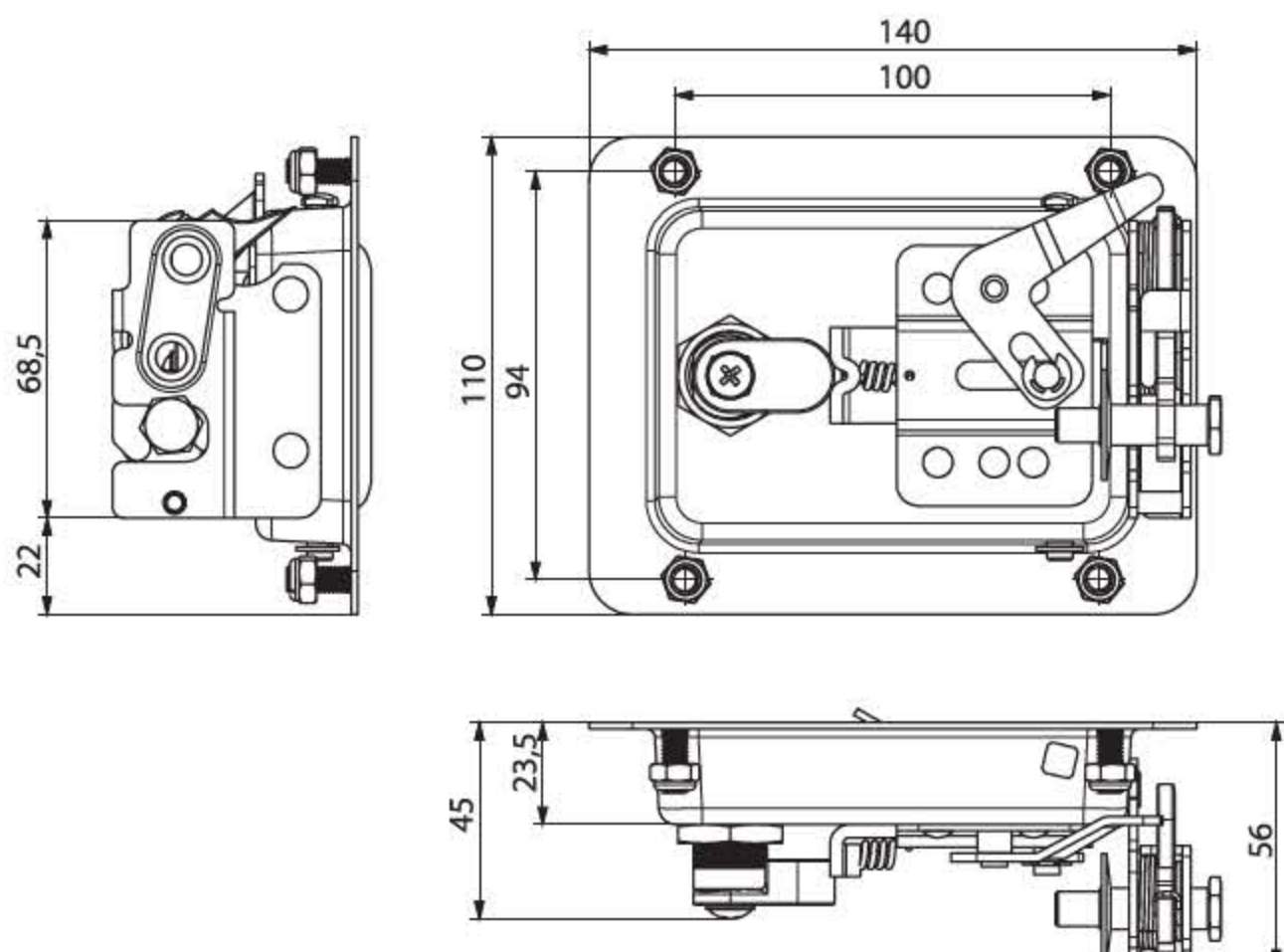

- Padlatch with integrated Rotary Latch
- Slam-shut operation
- Striker bolt is required
- Can open from inside by moving cable

MATERIAL
 BODY: Steel
 HANDLE: Steel
 CAM: Zamak DIN-EN 1774-ZnAl4Cu1
 SEAL: Polyurethane
 ROTARY LATCH: Steel

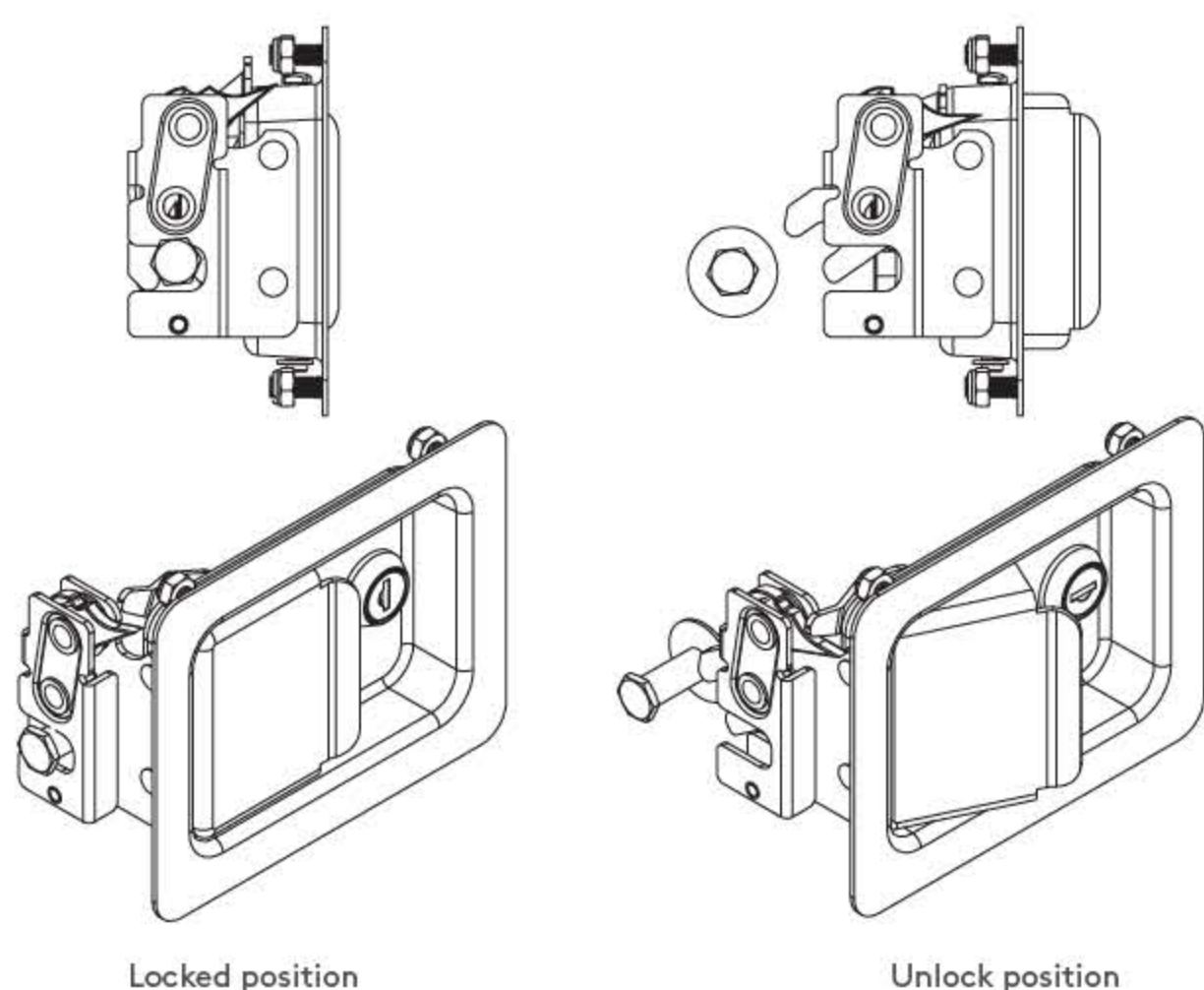

SB.1

STRIKER BOLT (MINI)



MATERIAL
 BODY: Steel
FINISH
 Zinc Plated

PRODUCT CODE

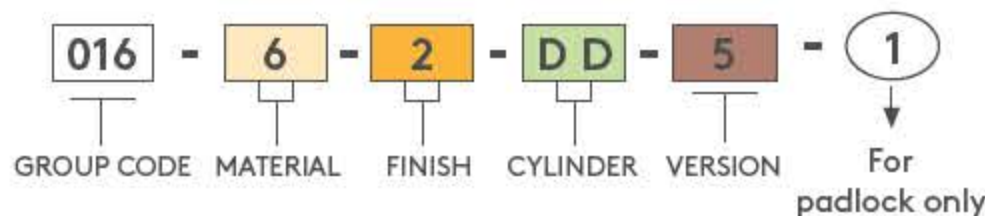

SPECIFICATIONS		DD
No cylinder		00
Stainless steel dust cap (Keyed alike)		03
Stainless steel dust cap (Keyed differ)		32

MATERIAL	M	FINISH	F
Steel	6	Black coated	2

PUSH-TO-CLOSE LOCK

016



V : 1

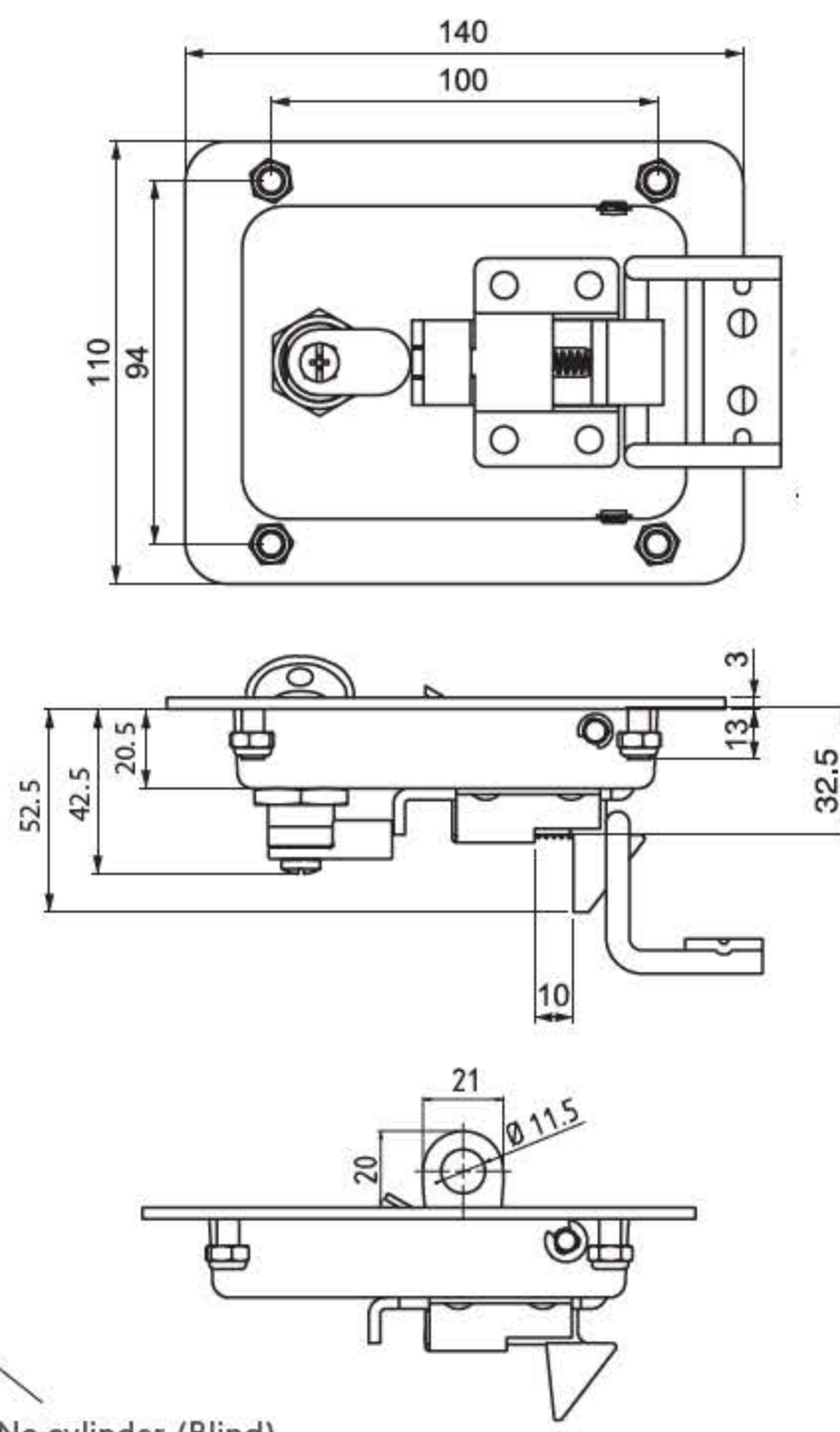

- Stainless steel version
- Slam-shut operation
- Brass cam
- Striking plate required
- Can open from inside by moving cam

APPLICATIONS
 Generators, compressors, electric panels, machinery covers

MATERIAL
 BODY: Steel
 HANDLE: Steel
 CAM: Brass
 SCREW: Stainless steel
 SEAL: Polyurethane

FINISH
 Black coated

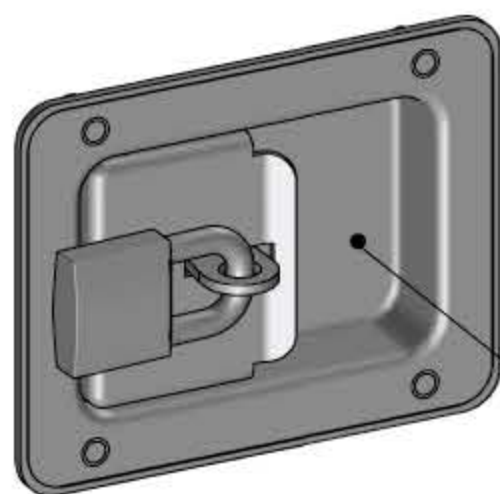

1 Padlock application

No cylinder (Blind)

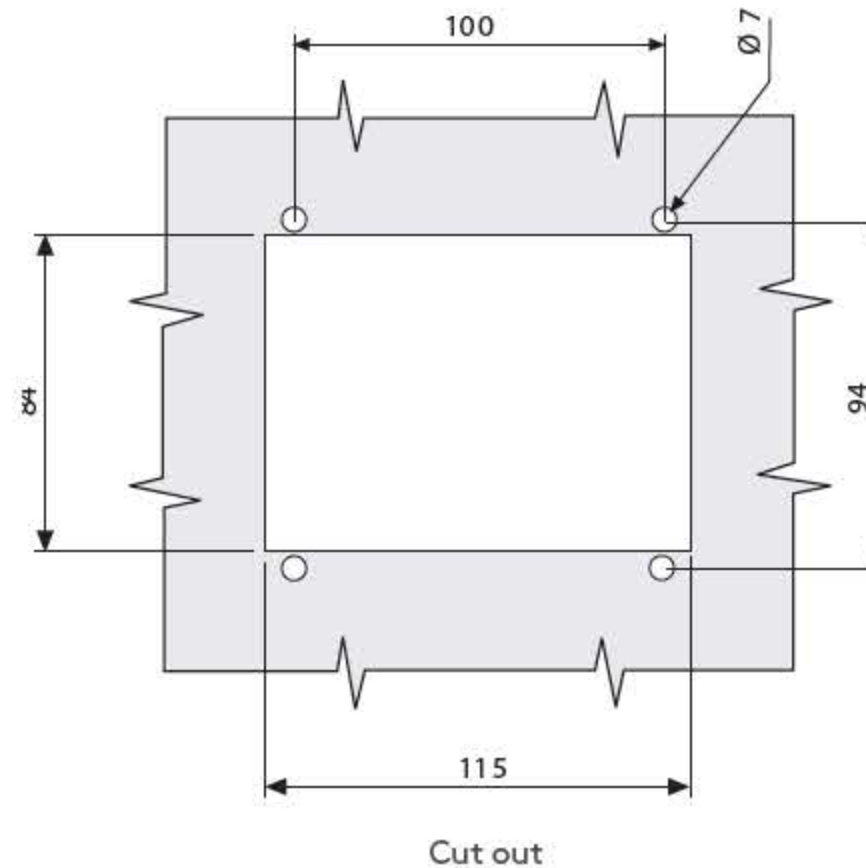
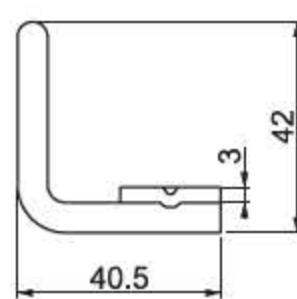
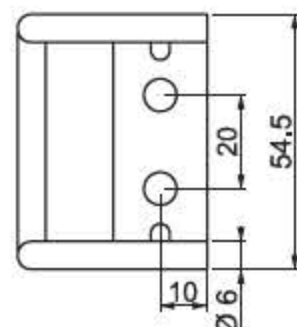

CAM STRIKING PLATE

016 A71



- Striking plate
- Custom sizes available

MATERIAL
 Steel

FINISH
 Zinc plated

PRODUCT CODE

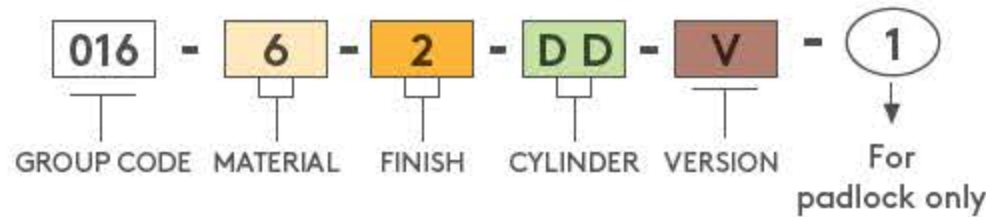

SPECIFICATIONS		DD
No cylinder (Blind)		00
Stainless steel dust cap (Keyed alike)		03
Stainless steel dust cap (Keyed differ)		32

MATERIAL	M	FINISH	F
Steel	6	Black coated	2

